

ATTACHED GARAGE



Reg Churko

306-728-7692 (Cell)

Email: reg@rcinspections.ca

Online: www.rcinspections.ca

How are trusses constructed?

How are trusses attached to dwelling?

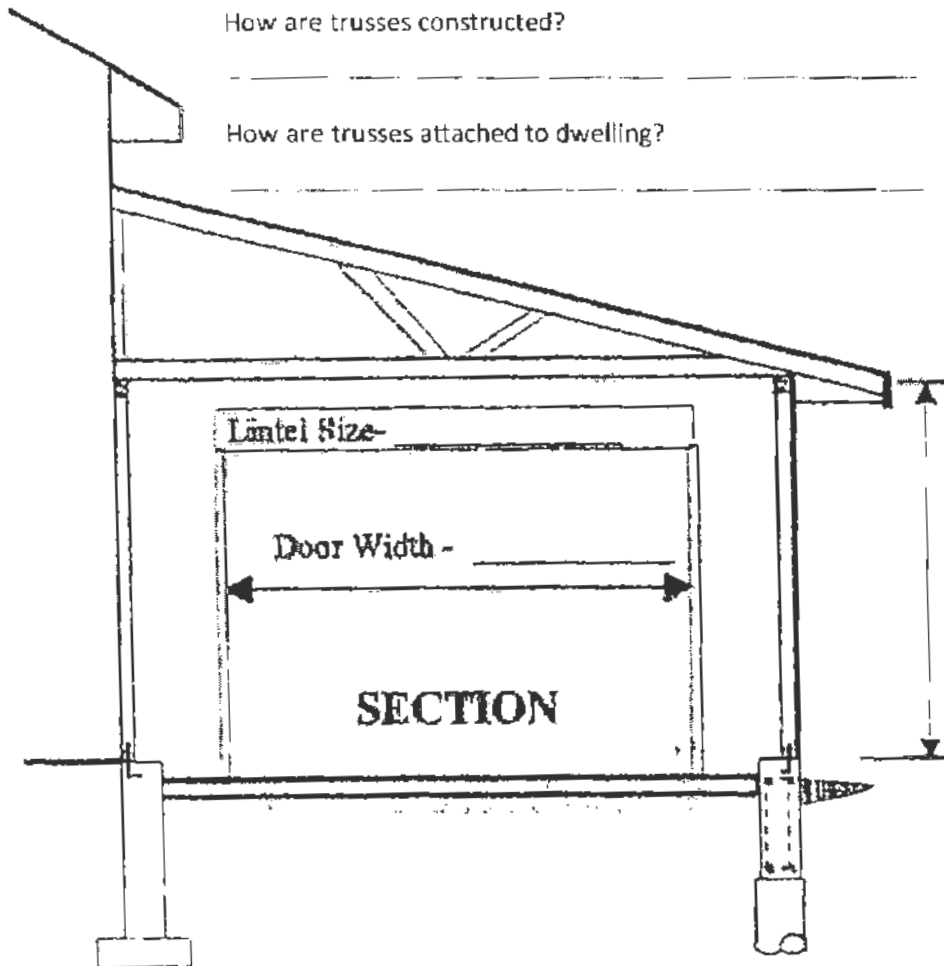

☐ Foundation Wall

Foundation Height _____

Wall Thickness _____

Footing Size: Width _____
Thickness _____

☐ Grade Beam & Piles

Pile Diameter _____

Pile Depth _____

Beam Size: Width _____
Height _____

Rebar: In Pile _____

In Beam _____

Pile -to- Beam _____

Roof:

Type of roof shingles _____

Type & thickness of roof sheathing _____

Spacing of roof trusses _____

Slope of roof _____

Width of overhang _____

Exterior Wall:

Type of siding _____

Type of Bldg. Paper/House Wrap _____

Type & thickness of wall sheathing _____

Size and spacing of studs _____

Height of wall _____

Type, size and spacing of anchor bolts _____

Wall Between House and Garage:

N/A

Wall to be constructed as a vapour tight separation.

No openable windows permitted.

Construction must resist the passage of gas and exhaust fumes from entering the dwelling.

Slab:

Thickness of slab _____

Type of sub base _____

Sloped outdoors _____

Construction Joint between house and slab _____

CODE REQUIREMENTS

Door into House:

Weather stripped ☐

Self-closer ☐

Deadbolt Lock ☐

Blocked at lock-height to frame ☐

Hinges secured to solid wood frame ☐

Note: Air duct systems cannot be interconnected with other parts of the dwelling unit.

Note: The foundation must extend to the same depth or greater than the house foundation.